

## Sheave PA with Cylindrical Roller Bearings

---

### Product information



Made fully out of Polyamid, plastic wire rope sheaves are the most lightweight sheaves in the Ropeblock portfolio. They come in many sizes, up to approx. 1,000 mm (for larger diameters a hybrid solution can be considered). Plastic sheaves are cost efficient and usually available from stock.

... [Read more](#)

---

**Material:** Polyamide

**Note:** Plastic sheaves are not suitable for all conditions!

## Sheave PA with Cylindrical Roller Bearings

### Blueprint

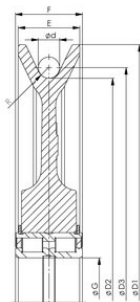

### Technical data

Part code	Rope Ø range mm	Shaft Ø mm	Groove radius	Sheave dia. mm	Bearing	øD2 mm mm	øG mm mm	R mm	øD1 mm mm	øD3 mm mm	E mm	F mm	ød mm mm	Weight kg
SE.260.5010.7.K	13	50	7	300 / 260	SL04 5010PP	260	50	7	300	272	34	40	13	2.9
SE.285.5012.7.K	13	60	7	325 / 285	SL04 5012PP	285	60	7	325	297	34	46	13	3.9
SE.352.5013.9.5.K	13	65	9.5	400 / 352	SL04 5013PP	352	65	9.5	400	369	42	46	17	5.5
SE.352.5013.8.5.K	16	65	8.5	400 / 352	SL04 5013PP	352	65	8.5	400	368	42	46	16	5.6
SE.352.5016.8.5.K	16	80	8.5	400 / 352	SL04 5016PP	352	80	8.5	400	368	50	60	16	7.6
SE.528.5018.8.5.K	16	90	8.5	596 / 528	SL04 5018PP	528	90	8.5	596	544	62	67	16	15.3
SE.400.5018.10.K	18	90	10	460 / 400	SL04 5018PP	400	90	10	460	418	60	67	18	10.81
SE.400.160.10.K	18	160	10	460 / 400	SL04 160PP	400	160	10	460	418	72	80	18	13.54
SE.400.5024.10.K	18	120	10	460 / 400	SL04 5024PP	400	120	10	460	418	72	80	18	14
SE.400.5018.10.5.K	19	90	10.5	460 / 400	SL04 5018PP	400	90	10.5	460	419	60	67	19	9.8
SE.482.5018.11.5.K	21	90	11.5	560 / 482	SL04 5018PP	482	90	11.5	560	503	62	67	21	14
SE.482.160.11.5.K	21	160	11.5	560 / 482	SL04 160PP	482	160	11.5	560	503	72	80	21	17.2
SE.482.5024.11.5.K	21	120	11.5	560 / 482	SL04 5024PP	482	120	11.5	560	503	72	80	21	17.54
SE.482.5018.12.K	22	90	12	558 / 482	SL04 5018PP	482	90	12	558	504	62	67	22	13
SE.528.5018.12.K	22	90	12	596 / 528	SL04 5018PP	528	90	12	596	550	60	67	22	15

## Sheave PA with Cylindrical Roller Bearings

### Technical data

Part code	Rope Ø range mm	Shaft Ø mm	Groove radius	Sheave dia. mm	Bearing	øD2 mm mm	øG mm mm	R mm	øD1 mm mm	øD3 mm mm	E mm	F mm	ød mm mm	Weight kg
SE.528.5018.13.K	24	90	13	596 / 528	SL04 5018PP	528	90	13	596	552	62	67	24	15
SE.528.5024.13.K	24	120	13	596 / 528	SL04 5024PP	528	120	13	596	552	72	80	24	20.9
SE.528.160.13.K	24	120	13	596 / 528	SL04 160PP	528	120	13	596	552	72	80	24	22.1
SE.350.5014.14.K	26	70	14	416 / 350	SL04 5014PP	350	70	14	416	376	52	54	26	5.9
SE.528.5018.14.K	26	90	14	596 / 528	SL04 5018PP	528	90	14	596	554	62	67	26	14.9
SE.630.160.15,5.K	28	160	15.5	710 / 630	SL04 160PP	630	160	15.5	710	658	75	80	28	28