

Clevis Load Pin Pewag KBSW

Product information

Standard clevis load pins for pewag clevis system.
It is easy to operate, with an outstanding safety factor.
For a few parts special pins must be used (2nd table).

[... Read more](#)



Marking: According to standard, Grade 10 and the manufacturer logo PWW.
Standard: EN 1677-1

Grade: 10

Clevis Load Pin Pewag KBSW

Blueprint

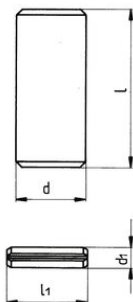

Technical data

Part code	Code	L mm	D, mm	L1mm mm	D1mm mm	Weight kg
11.11PEW46538	KBSW 5/6	16,5	7,4	16	2,5	0.006
11.11PEW46555	KBSW 7	23	9	22	3	0.01
11.11PEW46557	KBSW 8	23	10	22	3	0.01
11.11PEW46558	KBSW 10	29,5	12,5	28	3,5	0.03
11.11PEW46560	KBSW 13	37	16	36	4	0.06
11.11PEW46562	KBSW 16	52	20	40	4,5	0.1
11.11PEW46563	KBSW 19/20	73	24	50	5	0.2
11.11PEW46571	KBSW 22	71	27	55	5	0.32
11.11PEW84749	KBSW 26	86	33	55	5	0.58

Clevis Load Pin Pewag KBSW

Art No	Code	d x l (mm)	For accessory part
11.11PEW58951	KBS-KLH/KLHW PWH 6	7,5 x 17,5 + 7,4 x 16,5	KLH/KLHW-PWH 5/6
11.11PEW58952	KBS-KLH/KLHW PWH 7	9 x 22,5	KLH/KLHW-PWH 7
11.11PEW58953	KBS-KLH/KLHW PWH 8	10 x 22,5 + 10 x 23	KLH/KLHW-PWH 8
11.11PEW58950	KBS-KLH/KLHW PWH 10	13 x 31,5 + 12,5 x 29,5	KLH/KLHW-PWH 10
11.11PEW58954	KBS-KLH/KLHW PWH 13	16 x 42 + 16 x 37	KLH/KLHW-PWH 13
11.11PEW58955	KBS-KLH/KLHW PWH 16	21 x 51,5 + 20 x 52	KLH/KLHW-PWH 16
11.11PEW58989	KBS-KSS 7	8 x 22,5	KSS 7
11.11PEW58990	KBS-KSS 8	10 x 27,2	KSS 8
11.11PEW58991	KBS-KSS 10	12 x 32,2	KSS 10
11.11PEW58992	KBS-KSS 13	16 x 45,7	KSS 13