

Sheet Metal Plate Hook Pewag BWW

Product information



BWW Sheet metal plate hooks are designed for the assembling of chain slings. They serve for loading and transporting sheet metal stacks and plates. For lifting sheet metal stacks and boards.

Recommended angle of inclination of the sling: β 15-30°.

Use min. 3-leg chain sling.

[... Read more](#)

Material: High duty grade 10.

Marking: According to standard, CE-marked, Pewag or PW, winner or 10, H16, batch code and type.

Temperature range: -40°C up to +380°C.

Finish: Orange powder coated.

Standard: EN 1677-1

Note: When lifting with BWW it is very important that the load is bum-free and the transport is done without vibrations. It is very important that the specified slope angle is maintained. Lifting clamps will be a safer alternative

Safety factor: 4:1

Grade: 10

Sheet Metal Plate Hook Pewag BWW

Blueprint

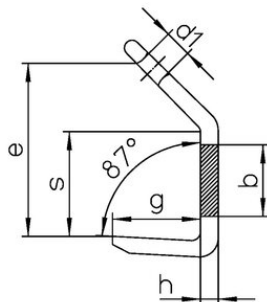

Technical data

Part code	Code	WLL ton	b mm mm	d1 mm mm	e mm mm	g mm mm	h mm mm	s mm mm	Weight kg
11.1466058	BWW 7/8	2.5	50	28	131	55	15	80	1.5
11.1484482	BWW 10	4	70	36	170	65	20	100	2.8
11.1466065	BWW 13	6.7	80	40	209	90	25	130	5.3
11.1466069	BWW 16	10	100	50	263	110	30	160	10.5
11.1466073	BWW 19/20	16	120	60	306	130	40	185	17.5
11.1466077	BWW 22	19	140	75	368	150	50	220	30.5