

Clevis Grab Hook Pewag KPW

Product information



KPW Clevis grab hooks are designed for the mounting of chain slings. For shortening and for slings that must not tighten. Reduction of load capacity not required thanks to 4-fold safety.

... [Read more](#)

Material: High duty grade 10.

Marking: According to standard, CE-marked, Pewag or PW, winner or 10, H16, batch code and type.

Temperature range: -40°C up to +380°C.

Finish: Orange powder coated.

Standard: EN 1677-1

Safety factor: 4:1

Grade: 10

Clevis Grab Hook Pewag KPW

Blueprint

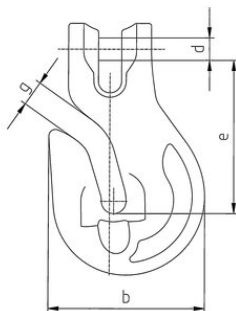

Technical data

Part code	Code	WLL ton	EWL	b mm	d mm	e mm	g mm	Weight kg
11.2118306	KPW 6	1.4	47	44	7	47	7	0.19
11.2127130	KPW 7	1.9	63	57	9	63	9	0.46
11.2132496	KPW 8	2.5	63	57	10	63	9	0.46
11.2127159	KPW 10	4	78	71	12	78	12	0.9
11.2127173	KPW 13	6.7	93	92	16	93	15	1.85
11.2127330	KPW 16	10	115	113	20	115	19	3.49
11.2160612	KPW 19/20	16	141	150	24	141	25	6.88
11.2160613	KPW 22	19	158	165	27	158	27	9.68

KPW 19/20 and KPW 22 is without saddle