

Safety Hook Pewag LHW

Product information



LHW Safety hooks are designed for the assembly of pewag connex system. This hook has a large eye, which is suitable for ropes and webbing slings. Automatically closes and locks under load and requires the load to be grounded before load can be released

Features:

- Self-closing and locking load hook
- Larger jaw opening than the HSW
- Locking set is available as a spare part

... [Read more](#)

Marking: According to standard, CE-marked

Temperature range: -40°C up to +380°C.

Finish: Orange powder coated.

Standard: EN 1677-3

Note: Not for welded system!

Safety factor: 4:1

Grade: 10

Safety Hook Pewag LHW

Blueprint

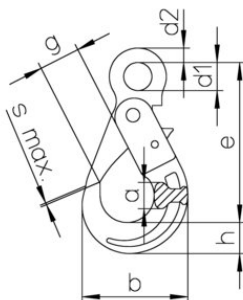

Technical data

Part code	Code	WLL ton	EWL	a mm	b mm mm	d1 mm mm	d2 mm mm	e mm mm	g mm mm	h mm mm	s max. mm mm	Weight kg
11.1649496	LHW 5/6	1.4	110	17	71	21	11	110	28	20	1	0.53
11.1649497	LHW 7/8	2.5	136	20	88	25	12	136	34	26	1	0.92
11.1649498	LHW 10	4	169	29	107	35	15	169	45	30	1	1.57
11.1649499	LHW 13	6.7	205	41	138	40	20	205	52	40	1.5	3.19
11.1649500	LHW 16	10	251	50	168	50	27	251	60	50	2	6.24
11.1667163	LHW 19/20	16	290	52	194	60	30	290	70	62	2	9.75
11.1667165	LHW 22	19	322	61	211	70	32	322	81	65	2	12.45
11.1606300	LHW 26	26.5	-	61	253	82	42	383	100	79	2	20