

Quick Release Link for Pear Socket Nemag

Product information



The Nemag Quick Release Link has been balanced and perfected to become the most reliable, quickest and safest coupling method for ropes and chains. The contact surface of the C-section has been hardened, which considerably lengthens the life span. The construction of the locking piece ensures reliable functioning; even under severe circumstances. The locking pieces are interchangeable.

Optional: Nemag also supplies a key especially designed for the Quick Release Link. This key has a hexagonal head that fits into the keyhole of the locking piece. The horizontal handle provides sufficient grip to be able to open or close any locking piece with one short movement. The sharp end of the handle can be used to remove dirt on the outside (of the keyhole).

... [Read more](#)

Marking: According to standard, CE-marked

Standard: EN 1677-1

Warning: The working load is the recommended maximum load for grabbing operations when Quick Release Links and Rope Pear Sockets are passing over a special cable sheave. For other applications a safety factor in line with official international and national guidelines has to be adhered to.

Quick Release Link for Pear Socket Nemag

Blueprint

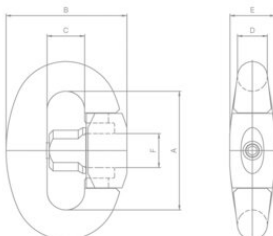

Technical data

Part code	Code	WLL	MBL	A mm	B mm	C mm	D mm	E mm	F mm	Weight kg
10.12NQRL04	RL-4	3	25	76	76	24.5	19	30	21	0.9
10.12NQRL05	RL-5	4.5	33	84	84	27	21	32.5	23	1.2
10.12NQRL06	RL-6	5	37.5	92	92	29.5	23	35	25	1.5
10.12NQRL07	RL-7	7	49	100	100	32	25	38	28	2
10.12NQRL08	RL-8	8	54	108	108	34.5	27	40.5	31	2.5
10.12NQRL09	RL-9	9.5	60	116	116	37	29	43.5	34	3.1
10.12NQRL10	RL-10	12	75	128	128	40.5	32	48	37	4.4
10.12NQRL11	RL-11	15	95	140	140	44	35	53	40	5.7
10.12NQRL12	RL-12	17	110	152	152	47.5	38	57	43	7.2
10.12NQRL13	RL-13	21	135	164	164	51	41	61.5	46	8.7
10.12NQRL14	RL-14	26	160	176	173	54	44	66	50	11
10.12NQRL15	RL-15	30	175	188	188	58	47	70.5	52	13.5
10.12NQRL17	RL-17	42.5	260	222	222	68	56	84	62	23