

## HJ G SN Hydraulic Locknut Cylinder

### Product information



Holmatro locknut cylinders (HJ) - Gravity return

#### Unique specifications gravity return:

- Suitable for lifting, tensioning in all positions
- Mechanical load locking; safe way of working with sustained load
- Flat saddle; prevents damage to the plunger, easy to replace with tilting saddle

#### Standard supplied with:

- High flow female coupler A118
- Flat saddle: in case of gravity return
- Tilting saddle: in case of hydraulic return

#### Also available:

- Saddles
- Hydraulic pump units 700bar to control your system
- Hydraulic hoses 700bar
- System components to complete your hydraulic system

... [Read more](#)

**Material:** Steel

## HJ G SN Hydraulic Locknut Cylinder

### Blueprint

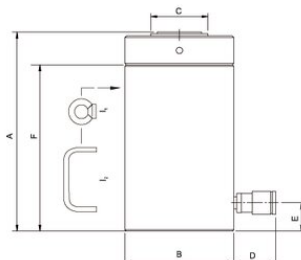

### Technical data

Part code	Code	WLL ton	Type	Stroke mm	Closed height mm	required oil cc	Capacity kN/t	Weight kg
16.40100082001	HJ 50 G 15 SN	50	I2	150	307	1,065	510.3 / 52	34
16.40100082000	HJ 100 G 15 SN	100	I1	150	323	2,150	1029.3 / 105	71
16.40100112136	HJ 150 G 15 SN	150	I1	150	363	3,207	1538.9 / 156.9	101
16.40100112083	HJ 250 G 15 SN	150	I1	150	385	5,195	2493.8 / 254.3	180