

HJ H Gravity Return Hydraulic Cylinder

Product information



Double acting, hydraulic return cylinder.

- Max. working pressure: 720 bar/ 72 Mpa
- Acting type: double
- Return type: hydraulic
- Usable in all positions
- Protected against ejection of plunger
- Protection against overpressure on return side
- Flat saddle. Prevents damage to the plunger and is easy to replace with tilting saddle.

Standard supplied with:

- High Flow female coupler A 118
- Flat saddle that prevents damage to the plunger and is easy to replace with tilting saddle.

Available on request:

- Cylinders manufactured in conformity with customer specifications
- Collar thread
- Base mounting holes

... [Read more](#)

Material: Steel

HJ H Gravity Return Hydraulic Cylinder

Blueprint

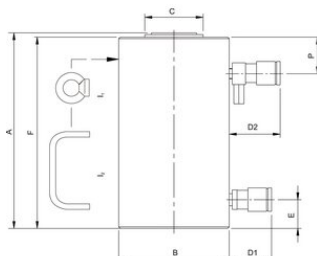

Technical data

Part code	Code	WLL ton	Type	Stroke mm	Closed height mm	Capacity kN/t	Weight kg
16.40100122002	HJ 50 H 15	50	I2	150	282	510.3 / 52	27
16.40100122022	HJ 50 H 30	50	I2	300	463	510.3 / 52	44
16.40100122009	HJ 100 H 5	100	I1	50	170	1029.3 / 105	29
16.40100122052	HJ 100 H 15	100	I1	150	309	1029.3 / 105	53
16.40100122054	HJ 100 H 30	100	I1	300	497	1029.3 / 105	85
16.40100122061	HJ 150 H 15	150	I1	150	317	1538.9 / 156.9	76
16.40100122062	HJ 150 H 30	150	I1	300	502	1538.9 / 156.9	128
16.40100122071	HJ 200 H 15	200	I1	150	327	2040.6 / 208.1	121
16.40100122084	HJ 300 H 15	300	I1	150	382	2933 / 299.1	240