

## HJ G Gravity Return Hydraulic Cylinder

### Product information



Holmatro high tonnage cylinders (HJ) – Gravity return

#### Unique specifications:

- Flat saddle; prevents damage to the plunger, easy to replace with tilting saddle

#### Standard supplied with:

- High flow female coupler A118
- Flat saddle

#### Also available:

- Tilting saddles

#### Also available:

- Hydraulic pump units 700bar to control your system
- Hydraulic hoses 700bar
- System components to complete your hydraulic system

... [Read more](#)

**Material:** Steel

## HJ G Gravity Return Hydraulic Cylinder

### Blueprint

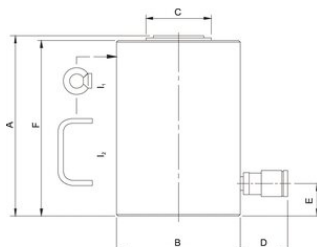

### Technical data

| Part code      | Code        | WLL ton | stroke length mm | Closed height mm | required oil cc | Type | Weight kg |
|----------------|-------------|---------|------------------|------------------|-----------------|------|-----------|
| 16.40100112073 | HJ 50 G 6   | 50      | 60               | 142              | 425             | -    | 12.5      |
| 16.40100112035 | HJ 50 G 15  | 50      | 150              | 282              | 1,064           | I2   | 27        |
| 16.40100112036 | HJ 50 G 30  | 50      | 300              | 463              | 2,127           | I2   | 39.5      |
| 16.40100112093 | HJ 100 G 6  | 100     | 60               | 158              | 860             | I2   | 29        |
| 16.40100112039 | HJ 100 G 15 | 100     | 150              | 309              | 2,145           | I1   | 51        |
| 16.40100112040 | HJ 100 G 30 | 100     | 300              | 497              | 4,290           | I1   | 82        |
| 16.40100112046 | HJ 150 G 15 | 150     | 150              | 317              | 3,207           | I1   | 74.6      |
| 16.40100112047 | HJ 150 G 30 | 150     | 300              | 502              | 6,414           | I1   | 125.3     |
| 16.40100112048 | HJ 200 G 15 | 200     | 150              | 327              | 4,253           | I1   | 120       |
| 16.40100112050 | HJ 300 G 15 | 300     | 150              | 382              | 6,225           | I1   | 238       |