

Thimble G-414SL, Crosby - Extra heavy (Shackle-Loc)

Product information



- Prevents the shackle from being removed and replaced in the field, which could compromise the certified integrity of the sling assembly.
- Available in Hot Dip galvanized. Crosby's shackle locking thimbles are galvanized after the welding of the wedge has been completed.
- Greater protection against wear and deformation of the wire rope eye.
- Longer service life.

... [Read more](#)

Material: Steel

Marking: According to standard

Finish: Hot-dip galvanised

Standard: EN 13411-1

Thimble G-414SL, Crosby - Extra heavy (Shackle-Loc)

Blueprint

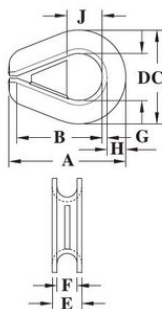

Technical data

Part code	Rope Ø range mm	Finish	A mm	B mm	C mm	D, mm	E mm	F mm	G, mm	H, mm	J mm	Weight kg/100pc
10.251036800	9-10	Galvanized	73	54	54	28,7	16,8	10,4	2,8	8,65	20,5	9.8
10.251036808	13-15	Galvanized	92	70	70	38,1	23,4	13,5	3,55	10,4	28,4	23.1
10.251036817	16	Galvanized	108	82,5	79,5	44,5	26,2	16,8	4,05	12,7	31,7	34.3
10.251036826	18-20	Galvanized	127	95,5	96,5	51	33	19,8	5,6	16,8	38,1	72
10.251036835	22	Galvanized	140	108	108	57	37,3	23,9	5,6	19,1	41,4	81
10.251036844	24-26	Galvanized	156	114	125	63,5	44,5	26,9	6,35	22,4	47,4	142
10.251036853	28-32	Galvanized	178	130	149	73	47,8	33,3	6,35	28,7	54,1	181
10.251036862	35-38	Galvanized	229	159	181	89	66,5	39,6	12,7	28,7	63,5	587