

Swivel Jaw / Jaw Crosby S2

Product information



Design: Swivel with jaws equipped with tapered roller thrust bearing.

Features:

- Suitable for frequent rotation under load.
- All swivels individually Proof Tested to 2 times the Working Load Limit.
- Pressure lube fitting provided
- All jaws complete with bolts, nuts and cotter pins.
- Other types and capacities up to 1250 t available on demand.

... [Read more](#)

Marking: CE-marked

Note: Always check before use if your steel wire rope is suitable for use with a swivel.

Warning: Not to be used on demolition- (wrecking-) balls!

Safety factor: 5:1

Swivel Jaw / Jaw Crosby S2

Blueprint

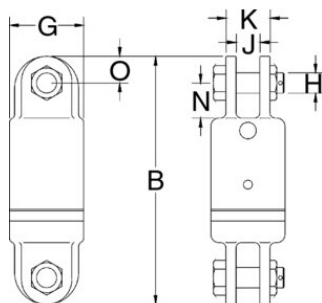

Technical data

Part code	Rope Ø range mm	WLL ton	Swivel No	B mm	G mm	H mm	J mm	K mm	N mm	O mm	Weight kg
11.46297020	13	3	3-S-2	236	70	19.1	22.4	41.1	33.3	25.4	4.37
11.46297226	16	5	5-S-2	262	76	22.4	25.4	57	41.1	28.4	6.21
11.46297422	19	8.5	8-S-2	321	102	25.4	39.5	71.5	54	35.1	11.9
11.46297627	22	10	10-S-2	426	114	38.1	44.5	86	89	44.5	20.8
11.46297823	26	15	15-S-2	435	127	38.1	44.5	86	89	44.5	28.5
11.46298127		25	25-S-2	527	152	51	51	117	93.5	60.5	64
11.46298225		35	35-S-2	527	165	51	51	117	93.5	60.5	70
11.46298323		45	45-S-2	641	178	57	63.5	127	102	76	107