

## Snatch Block H - Hook

---

### Product information



Intended for general lifting purposes. Can also be used for pulling. WLL in table applies for load on head fitting/hook.

**Design:** Snatch block type with covering side plates. Provided with swiveling hook with latch. Bronze bushed sheave in 2-4 tons blocks and roller bearings in larger sizes. Grease fitting in the shaft and cross head.

... [Read more](#)

---

**Material:** Steel.

**Marking:** Type, WLL and wire rope diameter.

**Finish:** Blue painted.

## Snatch Block H - Hook

### Blueprint

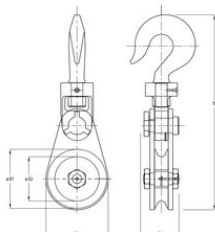

### Technical data

Part code	WLL ton	TA mm mm	TBmm mm	TC mm mm	Ø D1 mm mm	Ø D2 mm mm	Weight kg
16.15121030214	2	82	70	290	75	58	4
16.15121040414	4	120	70	358	115	90	6
16.15121060414	4	160	70	432	150	120	14
16.15121080814	8	210	93	549	200	165	16
16.15121101014	10	260	115	695	250	205	38
16.15121121214	12	310	133	797	300	250	56
16.15121081514	15	210	102	672	200	165	24
16.15121121514	15	310	133	797	300	250	65
16.15121142214	22	365	140	960	355	305	90
16.15121123014	30	310	193	993	300	250	125
16.15121163014	30	415	155	1,121	405	350	135
16.15121143514	35	365	193	1,028	350	280	130
16.15121245014	50	625	275	1,495	600	500	418