

Super Reeve Connector Swivel Sockets SCS-SW - with pin

Product information



- Dimensional tolerances depend on the manufacturing techniques applied and are different between machined components (pins) and cast components (socket bodies and wedges).
- All sockets are provided with an EN 10204-2.1 declaration of conformity, EN 10204-3.1 material certificate and can be provided with a 2006/42/EC declaration where applicable.
- Also surface finish e.g. hot dip galvanizing may add to the overall thickness and fork distance.

... [Read more](#)

Material: Quenched and tempered cast steel.

Finish: Hot dipped galvanized.

Super Reeve Connector Swivel Sockets SCS-SW - with pin

Blueprint

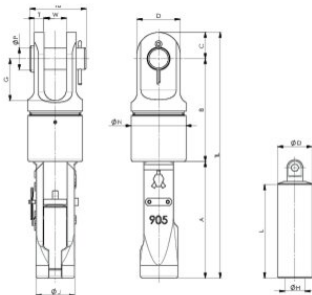

Technical data

Part code	Rope Ø range mm	MBL ton	Finish	A mm	B mm	C mm	D mm	G mm	N mm	L mm	T mm	TB mm	TLmm mm	Ø D mm	Ø H mm	ØJ mm mm	Ø P mm	W mm	Weight kg
10.10SCS-SW 902 P	13-16	25	Galvanized	182	157	32	58	60	76	98	14	85	371	32	19	56	30	32	7
10.10SCS-SW 903 P	16-19	40	Galvanized	208	186	40	70	70	93	114	16	95	434	40	22	65	35	38	11
10.10SCS-SW 904 P	20-22	55	Galvanized	238	208	45	80	80	105	130	19	110	491	44	26	77	41	44	17
10.10SCS-SW 905 P	23-26	75	Galvanized	266	235	60	98	96	125	142	22	128	561	52	31	88	50	51	26
10.10SCS-SW 906 P	27-29	90	Galvanized	290	262	65	108	107	135	159	25	142	617	58	34	96	57	57	34
10.10SCS-SW 907 P	30-32	125	Galvanized	327	292	73	120	118	150	177	28	155	692	64	36	110	63	63	49