

## Bow Shackle with Screw Pin Green Pin® MLVI, Stainless Steel

### Product information



The Green Pin® Stainless Steel Bow Shackle is a grade 5 bow shackle with a screw collar pin. The screw pin enables quick (dis)assembly which makes the shackle perfect for rigging activities in which assembly and disassembly occur relatively frequently. The Green Pin® Stainless Steel Bow Shackle can be used for both one-leg and multi-leg systems. The shackle is available in a range with a working load limit from 0.4 up to 6 ton.

Certification on request: 2.1, 2.2, 3.1

[... Read more](#)

**Material:** AISI 316

**Marking:** CE-marked, WLL

**Temperature range:** -40°C up to +200°C

**Finish:** Polished.

**Safety factor:** 5:1

**Grade:** 5

## Bow Shackle with Screw Pin Green Pin® MLVI, Stainless Steel

### Blueprint

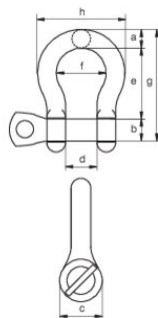

### Technical data

WLL ton	Size	Part number	a mm	b mm	c mm	d mm	e mm	f mm	g mm	h mm	Weight kg
0.4	56	MLV0.4I	8	8	16	16	32	25	56	41	0.06
0.6	67	MLV0.6I	10	10	19	20	40	28	67	48	0.12
0.9	79	MLV0.9I	12	12	24	25	48	36	79	59	0.2
1.5	87	MLV1.5I	13	16	31	24	52	35	87	60	0.32
2.5	108	MLV2.5I	16	20	38	28	64	42	108	71	0.58
3	125	MLV3I	19	22	44	32	72	50	125	87	0.96
4	145	MLV4I	22	25	50	37	74	60	145	101	1.46
6	157	MLV6I	25	30	57	40	94	67	157	115	2.09