

ROV Spring Release Shackle Green Pin® P-5367

Product information

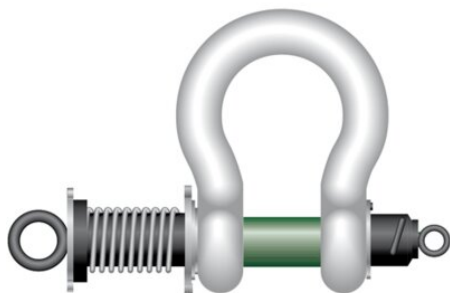

The Green Pin® Spring Release ROV Shackle is a grade 8 shackle developed specifically for (subsea) release operations with a remotely operated vehicle (ROV). The shackle has a specially designed quick release system that can be manipulated easily by a hydraulically operated ROV arm, without compromising safety. By activating the spring the shackle is disassembled quickly and safely. The Green Pin® Spring Release ROV Shackle is also suitable for use in extremely low temperatures (down to -60 °C / -76°F). Assembly of the shackle can be done by hand for the smaller sizes. A compression tool (sold separately) should be used for sizes with a working load limit of 42.5 ton and up. Of course, the Green Pin® Spring Release ROV Shackle conforms to a wide range of certifications. The Green Pin® Spring Release ROV Shackle is available in a range with a working load limit from 12 up to 150 ton.

Certification on request: 2.1, 2.2, 3.1, MTCa, LROS

[... Read more](#)

Material: Bow and pin alloy steel

Marking: CE-marked

Temperature range: -40°C up to +200°C

Finish: Bow white painted, pin green painted

Note: For in-line use only. This shackle is assembled with wire rope slings and a monkey's fist. For size starting from WLL 42.5 up to and including 150 t a special compression tool (sold separately) is required to assemble the shackle.

Safety factor: 5:1

Grade: 8

ROV Spring Release Shackle Green Pin® P-5367

Blueprint

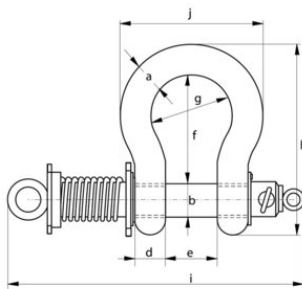

Technical data

WLL ton	a mm	b mm	c mm	d mm	e mm	f mm	g mm	h mm	i mm	j mm	Weight kg
12	32	35	72	32	51	115	83	201	291	147	5.24
13.5	35	38	80	35	57	133	92	227	301	162	7
17	38	42	88	38	60	146	99	249	360	175	9.25
25	45	50	103	45	74	178	126	300	370	216	15.5
35	50	57	116	50	83	197	138	334	400	238	20.4
42.5	57	65	130	57	95	222	160	377	460	274	39
55	65	70	145	65	105	260	180	433	490	310	42
85	75	83	162	75	127	329	190	527	587	340	67
120	95	95	208	91	147	399	238	646	687	428	123
150	105	108	238	102	169	410	275	688	727	485	168